



Part #	Description
WFO 9006	05 – 15 2nd Gen Toyota Tacoma, 03 – 09 4 th Gen 4 Runner

10076 Streeeter Road Suite #7, Auburn, CA 95602
 Phone: 530.268.9494 www.wfoconcepts.com

WFO Toyota Crossmember

BILL OF MATERIALS		
WM-39001	Qty. 2	Universal Side Link Mount
WM-39002	Qty. 1	Center Transmission Support
½" Bolts	Qty. 8	½"-13 x 1-½" Grade 8 Bolt Kits
TOOLS NEEDED		
Jack and/or Transmission Jack Metric and Standard Socket Set Metric and Standard Wrench Set Impact Gun Torque Wrench Cutoff wheels / Sawzall / Plasma Cutter Grinder Semi-Flat Black Spray Paint Tape Measure		

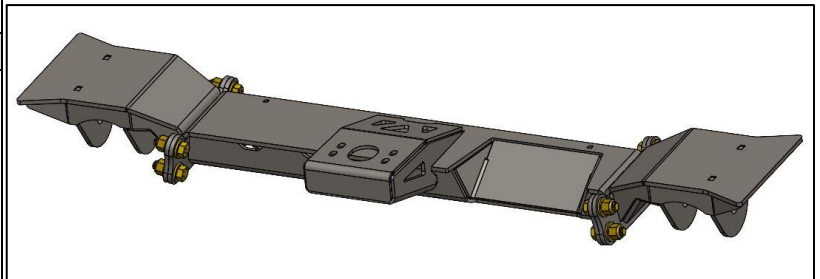

WARNING!
<p>*** Read all instructions thoroughly from start to finish before beginning the job! If these instructions are not properly followed, severe frame, suspension, tire, or body damage may result to the vehicle!</p> <p>*** WFO Concepts recommends that you exercise extreme caution when working under vehicles supported by jack stands.</p> <p>*** WFO Concepts recommends all installation to be performed by a professional shop/service technician. Product failure due to improper installation will not be covered under WFO's warranty policy.</p>

TECH NOTES:
<ol style="list-style-type: none"> 1) These directions are for the crossmember only. 2) Take extreme caution while removing and installing the crossmembers. Once the crossmember is removed the only thing holding the entire drivetrain in is the motor mounts. Make sure you have adequate jack stands and ratchet straps to ensure the back of the transfer case doesn't fall to the ground. 3) WFO Suspension Components should be installed on a well-supported vehicle. Either supported by using appropriately rated jack stands under the front and rear frame rails OR by using an automotive lift. 4) This suspension kit requires removal of factory mounted suspension brackets. Returning back to stock suspension will not be possible. 5) Major exhaust modifications are needed. You will need to slightly angle the Catalytic Converters, move the crossover pipe from the front side of the transfer case to the back, and tie the crossover pipe back into the muffler.

REMOVAL:

1. These instructions are only for removal and installation of your new WFO Crossmember.
2. Support the transfer case by either using jack stands under the rear yolk and/or large ratchet straps as a safety precaution back to the frame.
3. Start by removing the (4) center most bolts in the transmission mount with a 12mm socket and extension.
4. Remove the exhaust heat shield from the driver side of center section with a 12mm socket.
5. Lastly remove (2) bolts from each side of the center section with a 14mm socket and wrench.
6. Drop the center section out from the vehicle.
7. Using a cutoff wheel, gas torches, or plasma cutter to remove both side mounts of the old crossmember from the frame.
8. After removal, grind clean the entire area of the old crossmember.
9. Next you will need to remove your exhaust. Using a Sawzall or cutoff wheel, cut both sides of the exhaust just AFTER the catalytic converters. Remove the exhaust rubber mounts from the frame as well.
10. Also unbolt the Y-pipe that feeds into your muffler. Remove completely and set aside for later.
11. Grind and prep all areas for your new crossmember. Now is a good time to replace the transmission mount if needed.

INSTALLATION:

1. Locate the center crossmember section. Make sure the center transmission rubber mount is still bolted to the transmission. Take the center section and bolt it up to the mount using the (4) previously removed transmission mount bolts. The center transmission mount pedestal will point towards the front of the vehicle and the driveline notch will be on the Driverside.
2. Take the sides, which are universal from side to side, and bolt them up to the center. If you have $\frac{1}{2}$ "-13 regular nuts laying around, it will make the mock up stage easier so you not dealing with brand new nylock nuts.
3. Once all three pieces are bolted up together, jack up the crossmember tight to the bottom of the frame. Make sure it is centered on the frame rails as well as from front to back. Use factory locations on the frame to measure from. Look at the picture below; looking straight up from the bottom measure roughly 7-1/2" from where the frame ends to the back edge of the crossmember. 4 Runners may vary on this measurement. Just make sure that it's as square as you can get it in the vehicle. Tack the side pieces in place on the frame.

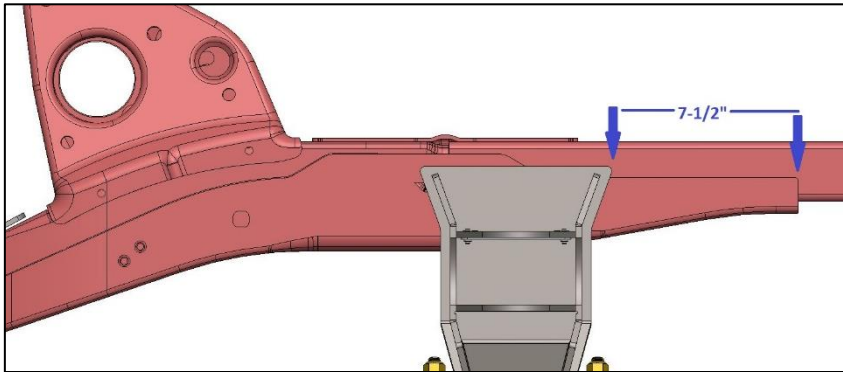

4. It's a good idea to progress with the install of all the links and other components to cycle the axle before final welding. Once satisfied, keep center installed and tight to lessen movement while you weld the sides on. Once cool, remove, paint, and re install. Torque all $\frac{1}{2}$ " Bolt hardware to 58 ft. lbs.

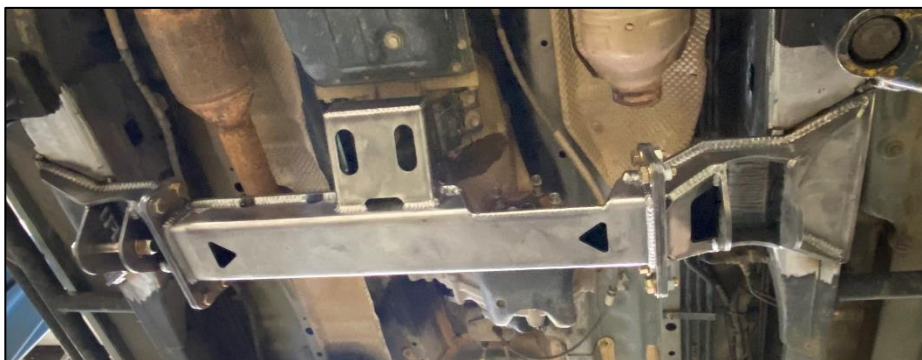



10076 Streeter Road Suite #7, Auburn, CA 95602
Phone: 530.268.9494 www.wfoconcepts.com

Follow us on all Social Media Platforms!
Remember to share your photos and tag #WFOCONCEPTS to be featured on our page!

